

REF	QTY	PART NO.	DESCRIPTION
		6801629	Equalizer Valve
1	1	6801611	Valve Body
2	1	601676	Fitting, 6-6
3	1	611293	Fitting, 12-12
4	1	6056977	Solenoid Valve
5	1	6014287	Coil - 12V
6	1	6093794	Fitting, 12-12
7	2	6092647	Relief Valve Cartridge

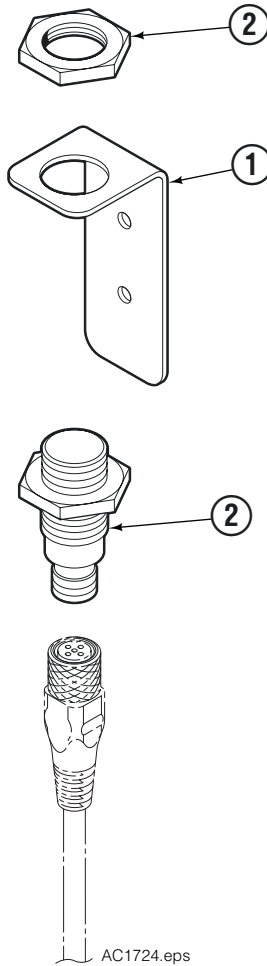

REF	QTY	PART NO.	DESCRIPTION
		6095969	Switch Assembly
1	1	6091430	Bracket
2	1	6092966	Switch

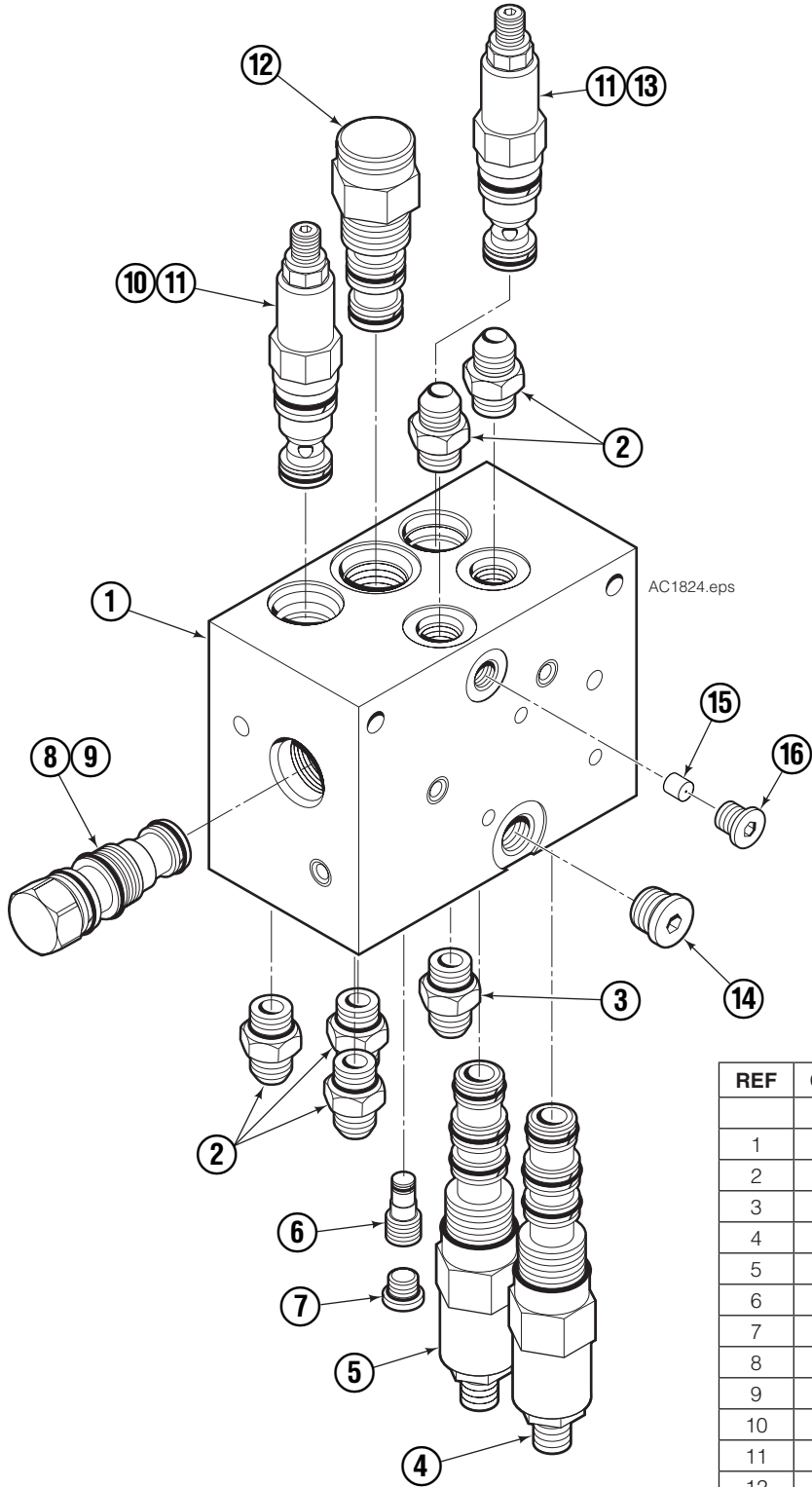

REF	QTY	PART NO.	DESCRIPTION
		6088041	HFC Valve ■
1	1	6088042	Valve Body
2	5	601377	Fittings, 8-8
3	1	604511	Fitting, 6-6
4	1	6091000	Pressure Sequence Valve Cartridge
5	1	6090999	Pressure Sequence Valve Cartridge
6	1	220865	Shuttle Valve
7	2	609234	Fitting, 4
8	1	210379	PO Check Valve Cartridge
9	1	6024964	Seal Kit
10	1	661676	Relief Valve Cartridge
11	2	661312	Seal Kit
12	1	6086327	Directional Valve Cartridge
13	1	6098001	Relief Valve Cartridge
14	1	604510	Fitting, 6
15	1	6054498	Orifice .020
16	1	663694	Fitting, 3

■ Refer to Glossary for flow requirements

Clamp Pressure – Pressure set to clamp a load.

Final Pressure (V2) – The final HFC adjusted clamp pressure applied when the load is hoisted.

Freelift Pressure (V5) – Pressure in the hoist line when the mast is in freelift state.

Hoist /Clamp Pressure (V6) – The hoist pressure combined with clamp pressure to hoist a load but keep the load clamped.

Mainlift Pressure (V5) – Pressure in the hoist line when the mast has extended above freelift.

Maximum Clamp Pressure (V4) – The maximum pressure set to clamp a load.

Overdrive System – A system to aid with increasing arm speed and allows an attachment to have higher clamping pressure when breaking out rolls.

Starting Pressure (V1) – The minimum clamp pressure that will be applied, even on light loads.

Static Hoist Pressure (V3) – The hoist pressure to achieve prior to hoisting.

Total Load Weight – The sum of the paper roll weight and clamp weight.

Do you have questions you need answered right now?

Call your nearest Cascade Service Department.
Visit us online at www.cascorp.com

AMERICAS

**Cascade Corporation
U.S. Headquarters**
2201 NE 201st
Fairview, OR 97024-9718
Tel: 800-CASCADE (227-2233)
Fax: 888-329-8207

Cascade Canada Inc.
5570 Timberlea Blvd.
Mississauga, Ontario
Canada L4W-4M6
Tel: 905-629-7777
Fax: 905-629-7785

Cascade do Brasil
Rua João Guerra, 134
Macuco, Santos - SP
Brasil 11015-130
Tel: 55-13-2105-8800
Fax: 55-13-2105-8899

EUROPE-AFRICA

**Cascade Italia S.R.L.
European Headquarters**
Via Dell'Artigianato 1
37050 Vago di Lavagno (VR)
Italy
Tel: 39-045-8989111
Fax: 39-045-8989160

Cascade (Africa) Pty. Ltd.
PO Box 625, Isando 1600
60A Steel Road
Sparton, Kempton Park
South Africa
Tel: 27-11-975-9240
Fax: 27-11-394-1147

ASIA-PACIFIC

Cascade Japan Ltd.
2-23, 2-Chome,
Kukuchi Nishimachi
Amagasaki, Hyogo
Japan, 661-0978
Tel: 81-6-6420-9771
Fax: 81-6-6420-9777

Cascade Korea
121B 9L Namdong Ind.
Complex, 691-8 Gojan-Dong
Namdong-Ku
Inchon, Korea
Tel: +82-32-821-2051
Fax: +82-32-821-2055

Cascade-Xiamen
No. 668 Yangguang Rd.
Xinyang Industrial Zone
Haicang, Xiamen City
Fujian Province
P.R. China 361026
Tel: 86-592-651-2500
Fax: 86-592-651-2571

**Cascade India Material
Handling Private Limited**
No 34, Global Trade Centre
1/1 Rambaugh Colony
Lal Bahadur Shastri Road,
Navi Peth, Pune 411 030
(Maharashtra) India
Phone: +91 020 2432 5490
Fax: +91 020 2433 0881

Cascade Australia Pty. Ltd.
1445 Ipswich Road
Rocklea, QLD 4107
Australia
Tel: 1-800-227-223
Fax: +61 7 3373-7333

Cascade New Zealand
15 Ra Ora Drive
East Tamaki, Auckland
New Zealand
Tel: +64-9-273-9136
Fax: +64-9-273-9137

**Sunstream Industries
Pte. Ltd.**
18 Tuas South Street 5
Singapore 637796
Tel: +65-6795-7555
Fax: +65-6863-1368

