



Installation Instructions

Sequence Valve Installation Kits

This sheet provides installation instructions for Cascade Sequence Valve Installation Kits. Each kit provides hoses, tubes and sequence valve to connect the hydraulic system of a K-Series Sideshifting Fork Positioner to the reeving supply hoses on a lift truck carriage.

Installation Kit 6085112

- 1 Install the sequence valve to the left hand lower carriage bar bracket with M8 sockethead capscrews and lockwashers. Tighten the capscrews to 15 ft.-lbs. (19 mm).
- 2 Install the tee fitting to the left hand sideshift cylinder port.
- 3 Connect hoses from the back of the sequence valve to the sideshift cylinder fittings. The hose with two 90° ends connects to the tee fitting.
- 4 Install a cable tie to secure the hoses.
- 5 Install the anchor bracket to the right hand lower carriage bar bracket using M8 hexhead capscrews and lockwashers. Tighten the capscrews to 15 ft.-lbs. (19 mm).

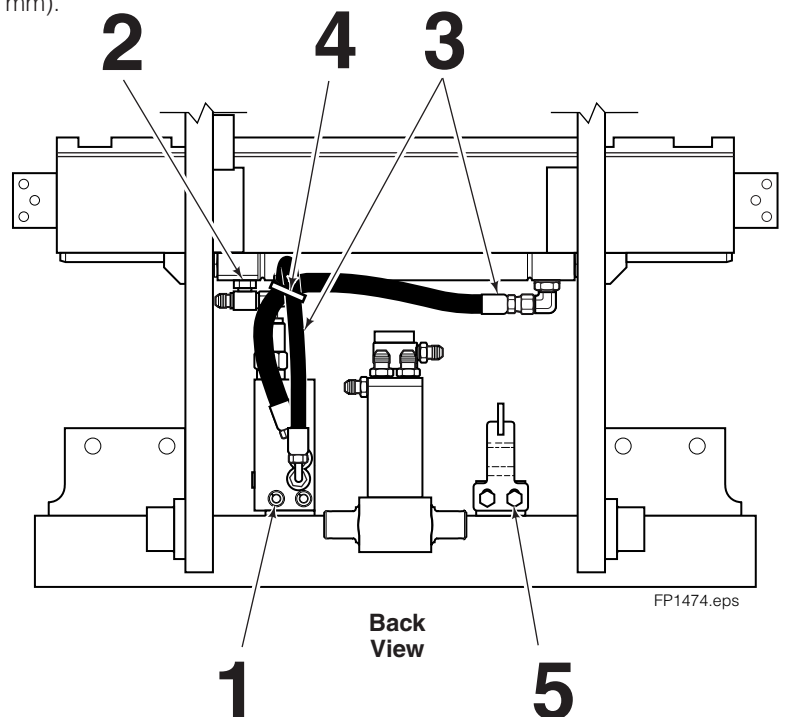

Part No. 6086075

cascade[®]
corporation

For Technical Support . . .

Call: 1-800-227-2233 Fax: 1-888-329-8207
Internet: www.cascorp.com
Write: Cascade Corporation, PO Box 20187, Portland, OR 97294

To Order Parts . . .

Call: 1-888-227-2233 Fax: 1-888-329-0234
Internet: www.cascorp.com
Write: Cascade Corporation, 2501 Sheridan Ave., Springfield, OH 45505

Installation Kit 6085112 (continued)

- 6** Install the large diameter tubes from the sequence valve to the internal reeving supply fittings.
- 7** Install the bulkhead straight fitting to the anchor bracket. Install with the jam nut on the outward side of the bracket.
- 8** Install the small diameter tube from the top sequence valve port to the anchor bracket bulkhead fitting.
- 9** Install hoses to the fork positioner manifold. During sideshifting, the hoses must track smoothly without binding.

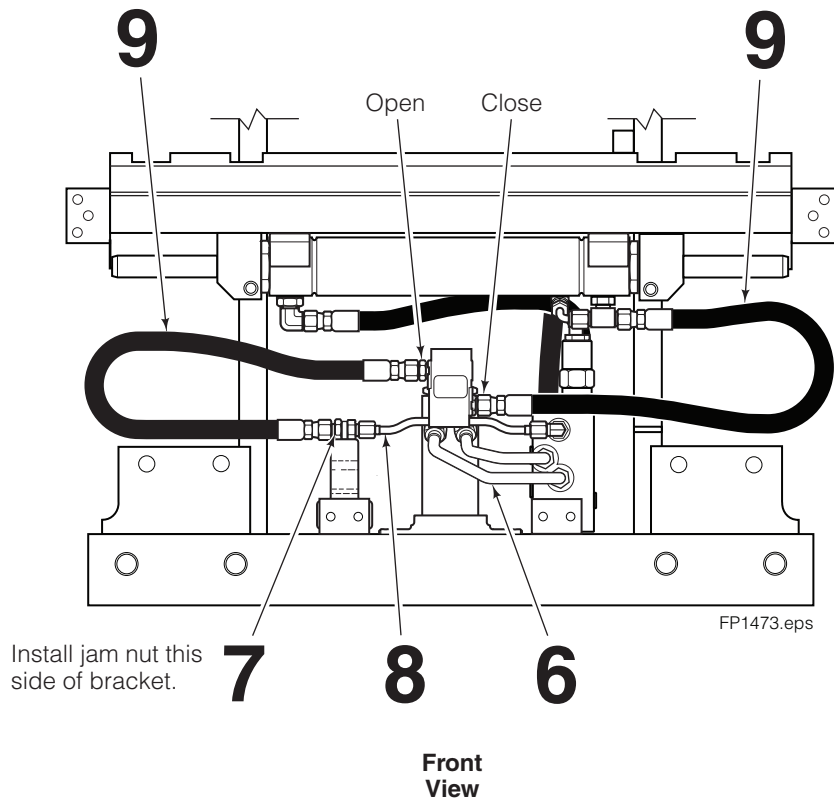

Operation

- Sideshift left and right several times.
- Engage the fork position function by sideshifting completely to one side. To the left engages open forks, to the right engages close forks. Open and close the forks several times.
- Check for operation in accordance with ANSI standards shown below.
- Check for leaks at the fittings, valve and cylinders.

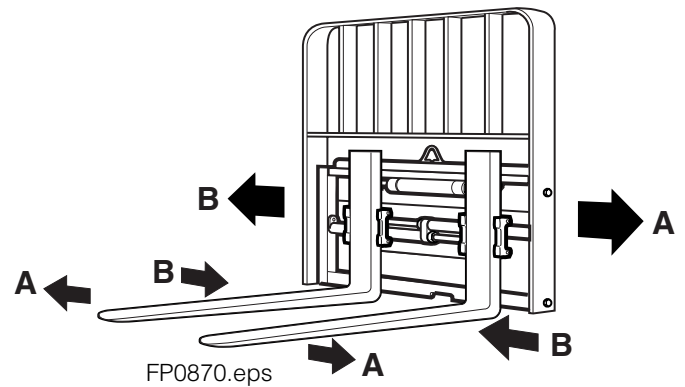
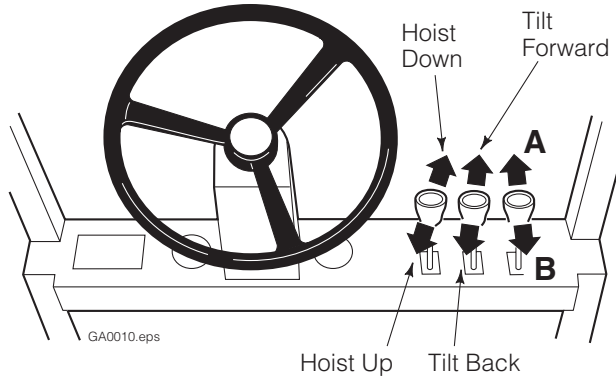

SIDESHIFT and SEQUENCE ACTIVATED FORK POSITIONING

- A** Sideshift Left – Forks Out
- B** Sideshift Right – Forks In

Sequence Valve Adjustment

The sequence valve is adjusted at the factory and should not require adjustment for installation.

- If adjustment is required, adjust the sequence valve by turning the screw in fully (CW). Turn the screw out (CCW) in 1/2 turn increments and test for fork movement. The forks should move only after sideshifting all the way left or right.

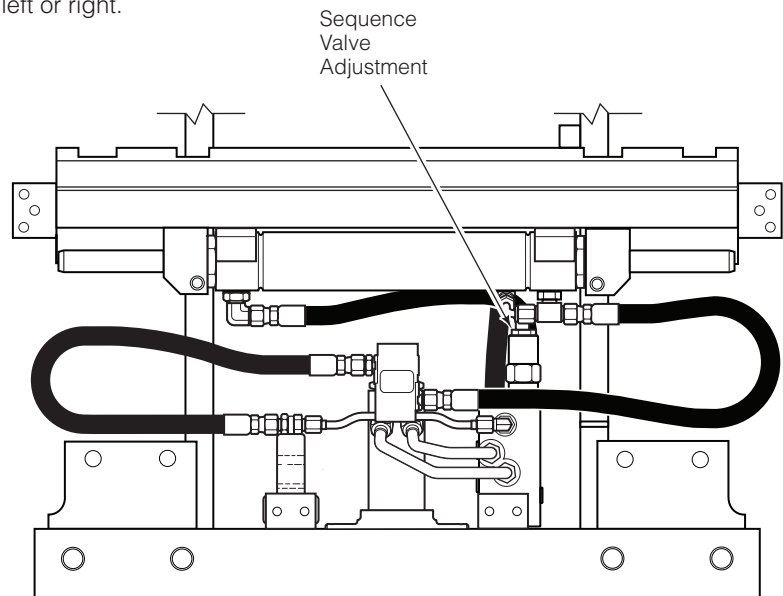

Parts List

Installation Kit 6085112

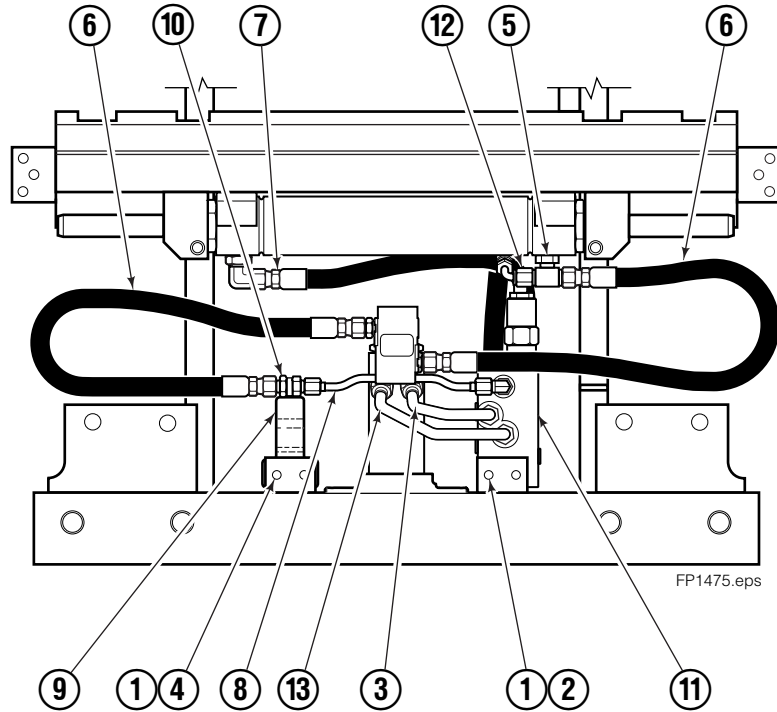

REF	QTY	PART NO.	DESCRIPTION
		6085112	Installation Kit
1	4	787384	Lockwasher, M8
2	2	768796	Capscrew, M8 x 35
3	1	6083687	Tube
4	2	767961	Capscrew, M8 x 16
5	1	6050638	Fitting, 6-4
6	2	6050405	Hose, 22.0 in.
7	1	6083572	Hose, 16.4 in.
8	1	6085123	Tube
9	1	6083697	Anchor Bracket
10	1	2373	Fitting, 4-4
11	1	6084957	Sequence Valve ●
12	1	6085086	Hose, 11.8 in.
13	1	6085128	Tube
14	1	200343	Cable Tie (not shown)

● See Valve page for parts breakdown.

Parts List

Sequence Valve

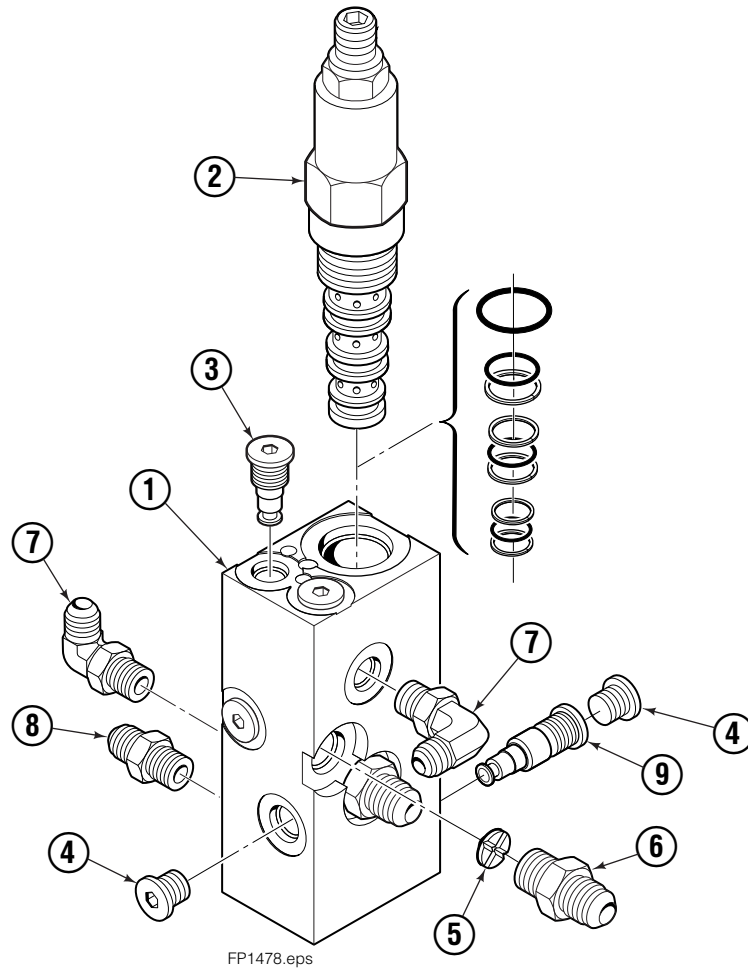

REF	QTY	PART NO.	DESCRIPTION
		6084957	Sequence Valve
1	1	6084958	Valve Body
2	1	6092633	Sequence Cartridge
3	2	220869	Check Valve
4	3	609234	Fitting, 4
5	2	564226	Restrictor Washer
6	2	604511	Fitting, 6-6
7	2	617917	Fitting, 4-4
8	1	617915	Fitting, 4-4
9	1	220865	Shuttle Valve

Do you have questions you need answered right now? Call your nearest Cascade Service Department. Visit us online at www.cascorp.com

AMERICAS

**Cascade Corporation
Parts Sales**
2501 Sheridan Ave.
Springfield, OH 45505
Tel: 888-CASCADE (227-2233)
Fax: 888-329-0234

Cascade Canada Inc.
5570 Timberlea Blvd.
Mississauga, Ontario
Canada L4W-4M6
Tel: 905-629-7777
Fax: 905-629-7785

Cascade do Brasil
Rua João Guerra, 134
Macuco, Santos - SP
Brasil 11015-130
Tel: 55-13-2105-8800
Fax: 55-13-2105-8899

EUROPE-AFRICA

**Cascade Italia S.R.L.
European Headquarters**
Via Dell'Artigianato 1
37050 Vago di Lavagno (VR)
Italy
Tel: 39-045-8989111
Fax: 39-045-8989160

Cascade (Africa) Pty. Ltd.
PO Box 625, Isando 1600
60A Steel Road
Sparton, Kempton Park
South Africa
Tel: 27-11-975-9240
Fax: 27-11-394-1147

ASIA-PACIFIC

Cascade Japan Ltd.
2-23, 2-Chome,
Kukuchi Nishimachi
Amagasaki, Hyogo
Japan, 661-0978
Tel: 81-6-6420-9771
Fax: 81-6-6420-9777

Cascade Korea
121B 9L Namdong Ind.
Complex, 691-8 Gojan-Dong
Namdong-Ku
Inchon, Korea
Tel: +82-32-821-2051
Fax: +82-32-821-2055

Cascade-Xiamen
No. 668 Yangguang Rd.
Xinyang Industrial Zone
Haicang, Xiamen City
Fujian Province
P.R. China 361026
Tel: 86-592-651-2500
Fax: 86-592-651-2571

**Cascade India Material
Handling Private Limited**
No 34, Global Trade Centre
1/1 Rambaugh Colony
Lal Bahadur Shastri Road,
Navi Peth, Pune 411 030
(Maharashtra) India
Phone: +91 020 2432 5490
Fax: +91 020 2433 0881

Cascade Australia Pty. Ltd.
1445 Ipswich Road
Rocklea, QLD 4107
Australia
Tel: 1-800-227-223
Fax: +61 7 3373-7333

Cascade New Zealand
15 Ra Ora Drive
East Tamaki, Auckland
New Zealand
Tel: +64-9-273-9136
Fax: +64-9-273-9137

**Sunstream Industries
Pte. Ltd.**
18 Tuas South Street 5
Singapore 637796
Tel: +65-6795-7555
Fax: +65-6863-1368

