

Technical Bulletin

Push/Pull Anchor Bracket Modifications to Mount on a Similar Width Sideshifter

This sheet describes how to modify a sideshifter to mount on a truck carriage that is the same width. The ends of the cylinder bracket need to be notched to clear the carriage fork stops.

- 1 Remove the anchor bracket from the Push/Pull.
- 2 Determine the size of notches required for both ends of the Push/Pull anchor bracket to clear the sideshifter upper fork stops and lay flat on the sideshifter.
- 3 Grind the notches. Repaint the bare metal to prevent corrosion.

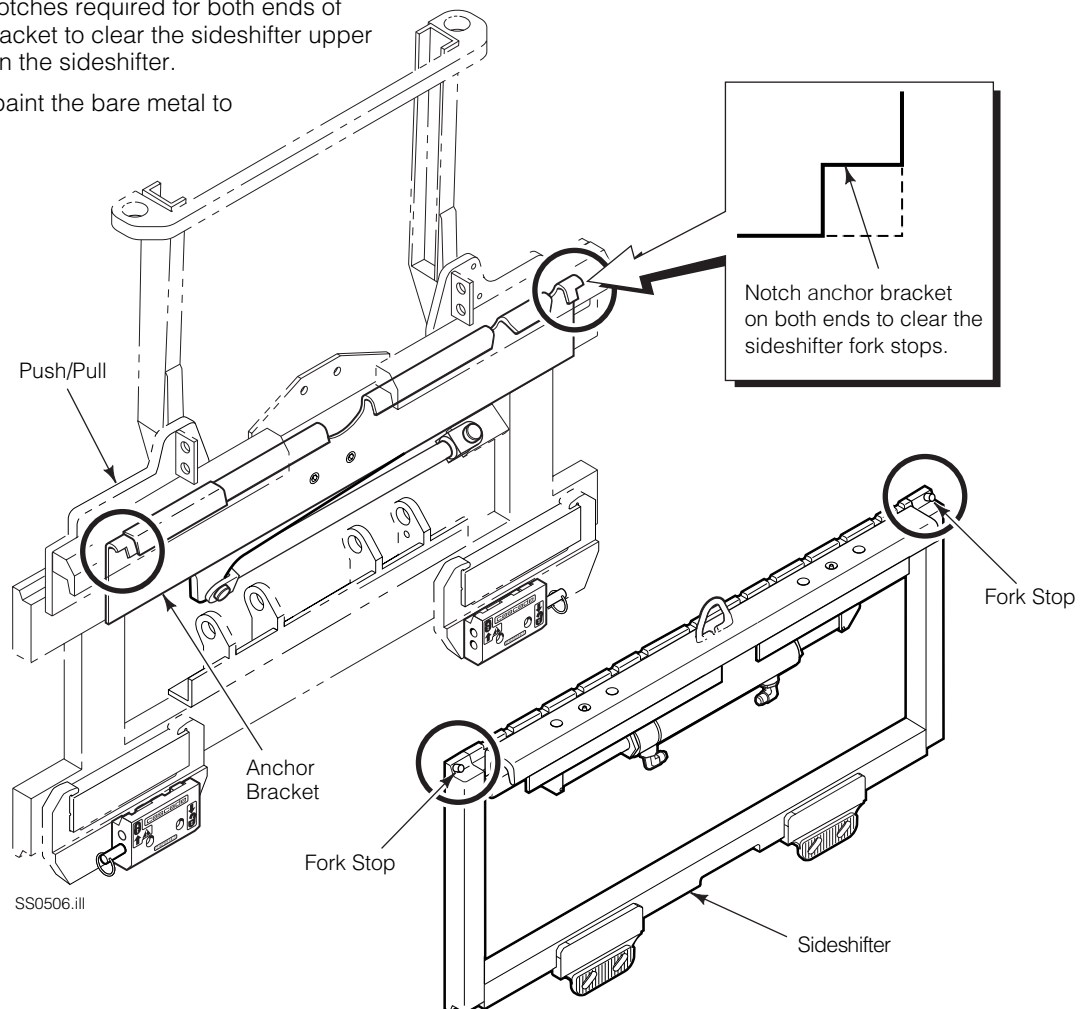

NOTE: This information should not be interpreted as the basis for warranty claims unless so designated.

cascade®
corporation

For Technical Support . . .

Call: 1-800-227-2233 Fax: 1-888-329-8207
 Internet: www.cascorp.com
 Write: Cascade Corporation, PO Box 20187, Portland, OR 97294

To Order Parts . . .

Call: 1-888-227-2233 Fax: 1-888-329-0234
 Internet: www.cascorp.com
 Write: Cascade Corporation, 2501 Sheridan Ave., Springfield, OH 45505

